

RECEIVED
13 APR 2007
PLANNING

OFFICE COPY
DO NOT REMOVE FROM FILE

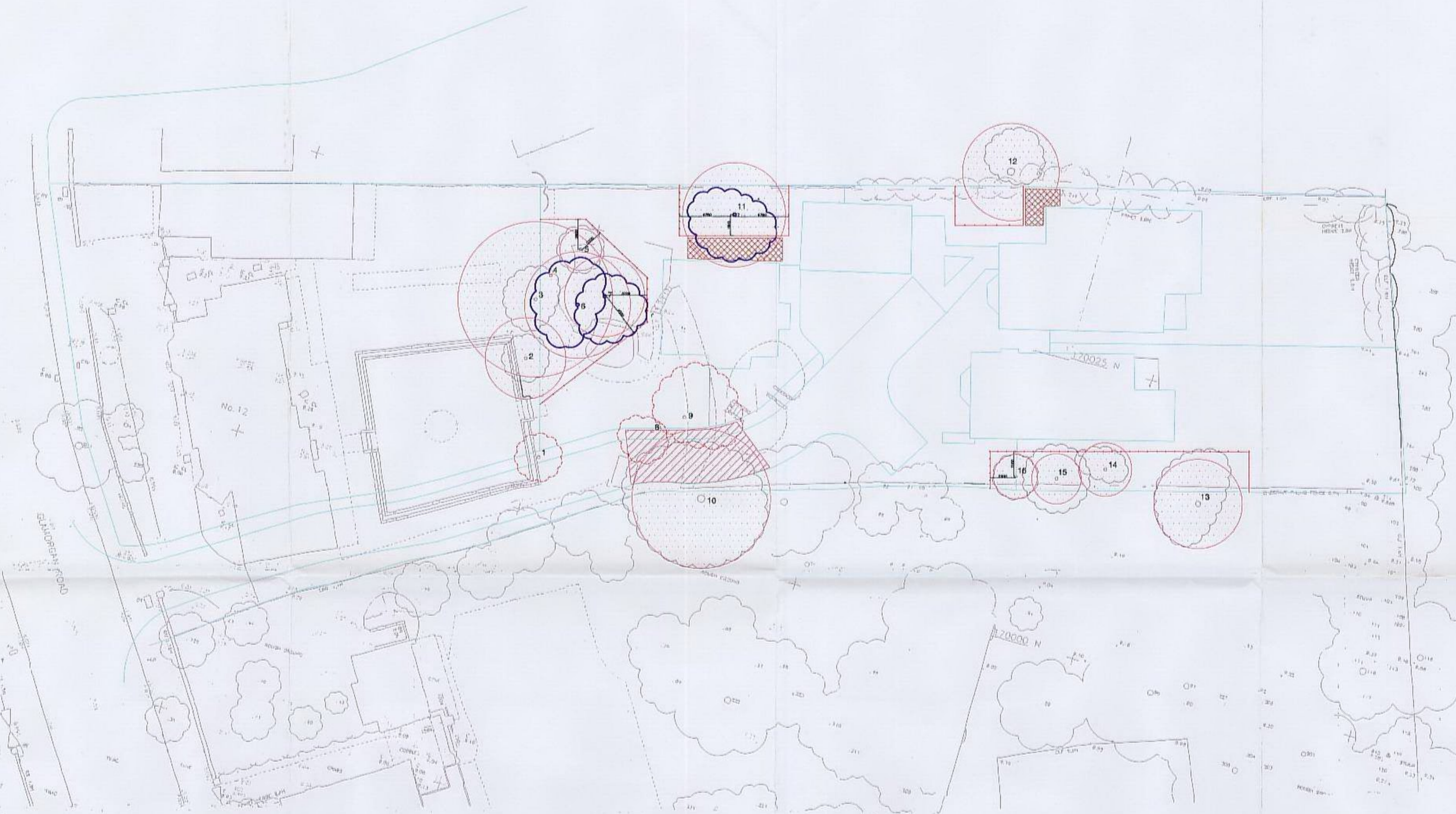

Tree No	Species	Ht (m)	Branch Spread (m)				Stem Dia (cm) @e	Height of crown clearance (m)	Age Class	Category	Estimated remaining contribution (yrs)	Condition Physiological / Structural	Preliminary management recommendations
			N	E	S	W							
1	Lawson Cypress	0	2	2	2	2	35m	0	Y	C	>10	Ubiquitous species	
2	Lawson Cypress	0	2	2	2	2	35m	0	Y	C	>10	Ubiquitous species	
3	Lawson Cypress	0	3	2	3	3	07m	2	Y	C	>10	Sparsely foliated with absence of branches on lower stem.	
4	Dead									R	<10	Dead	Remove
5	Norway Spruce	7	2	2	2	2	15	1	Y	C	>10	Poorly formed tree.	
6	Japanese Maple	7	4	2	4	4	40m	3	M	B	>20	Twin-stemmed from just above ground level showing signs of included bark and some deadwood within crown that is asymmetric due to presence of adjacent tree.	Remove all deadwood in excess of 25mm in diameter.
7	Japanese Maple	7	2	4	4	2	20	2	M	B	>20	Asymmetric due to presence of adjacent tree and some large deadwood within crown.	Remove all deadwood in excess of 25mm in diameter.
8	Cherry	7	1	2	3	3	22	2	Y	C	>10	Tree of poor form and shape with one of the dominant stems truncated and dead, the remainder having been severely pruned in the past.	
9	Cherry	6	5	5	2	3	30m	2	M	C	>10	Twin-stemmed from just above ground level forming a tight fork that is liable to separation and some deadwood within crown.	
10	Sycamore	13	5	6	6	7	60m	3	M	C	>10	Densely branched and foliated tree although appears to have been heavily reduced in the past and now re-grown.	
11	Yew	5	2	4	4	4	46m	0	Y	B	>20	Typical of neglected fruit there is much deadwood within crown.	
12	Scots Pine	9	4	3	1	3	35e	2	M	C	>10	Asymmetric crown and poor framework structure.	
13	Sycamore	11	5	2	4	4	32e	4	M	C	>10	Densely smothered in ivy preventing closer inspection.	
14	Fruit	3	2	2	1	3	23m	1	M	C	>10	Typical of neglected fruit there is much deadwood within crown.	
15	Sycamore	8	3	3	3	3	16	2	Y	C	>10	Growing tightly against boundary fence and in close proximity to neighbouring property.	
16	Fruit	4	2	2	2	2	19m	1	M	C	>10	Typical of fruit has much deadwood within crown.	

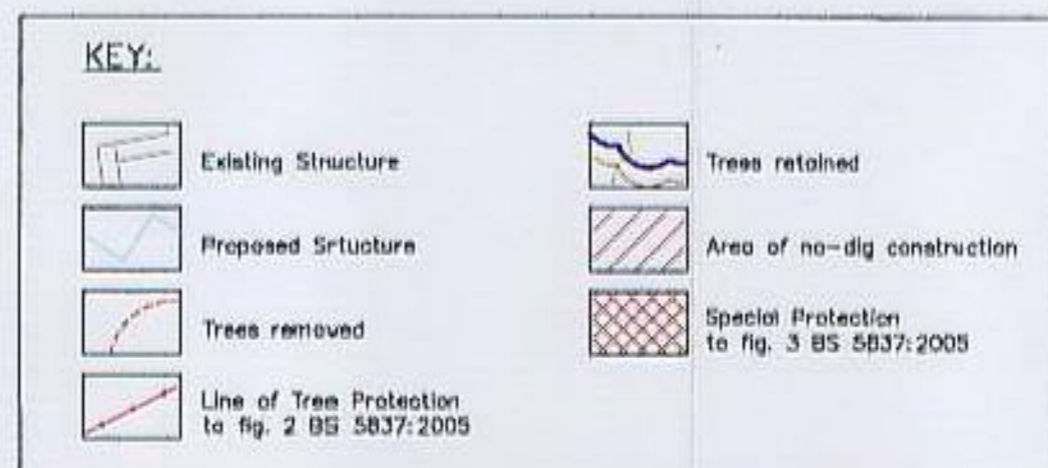

Note: The survey drawing pre-dates surrounding development and as such not all trees shown on the drawing were present at the time the tree survey was undertaken.

Client: Diadem Homes
 Project: 12 Glamorgan Road, Hampton Wick
 Title: Tree Protection Plan
 Status: For Information
 Scale: 1:200 A1 Date: April 2007
 Drawn: MAD Survey
 Dwg No: 6399/02
 Redwells Farm Redlands Lane
 West Farmham, Surrey GU10 5AS
 Telephone 01252 852395
 Facsimile 01252 851702
 Email: mail@iankeen.co.uk

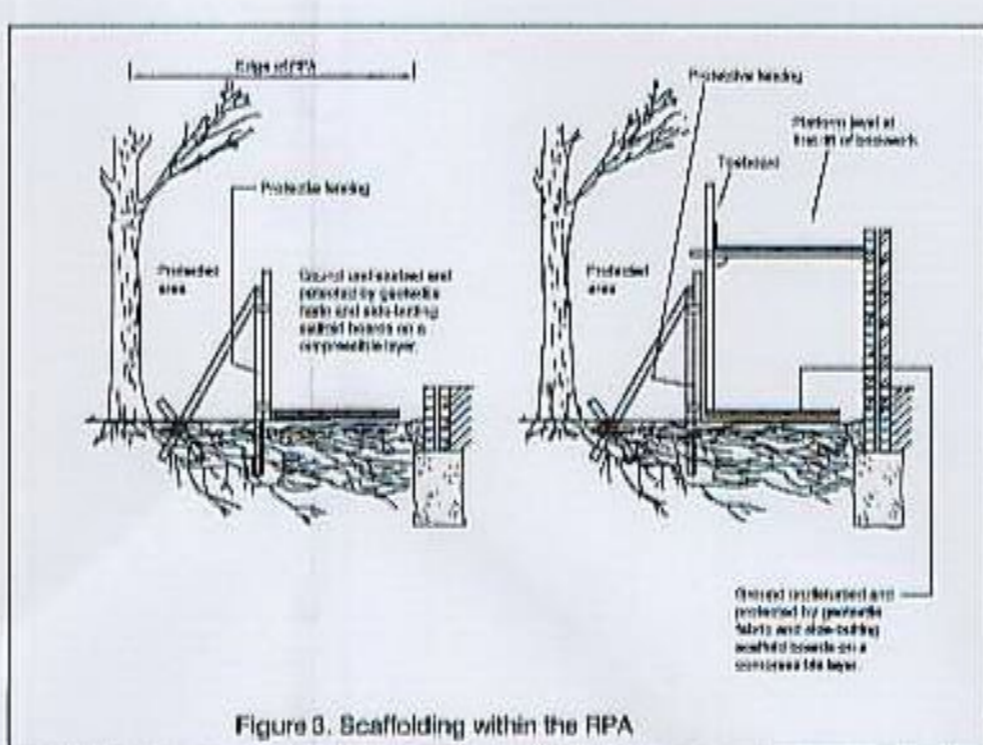
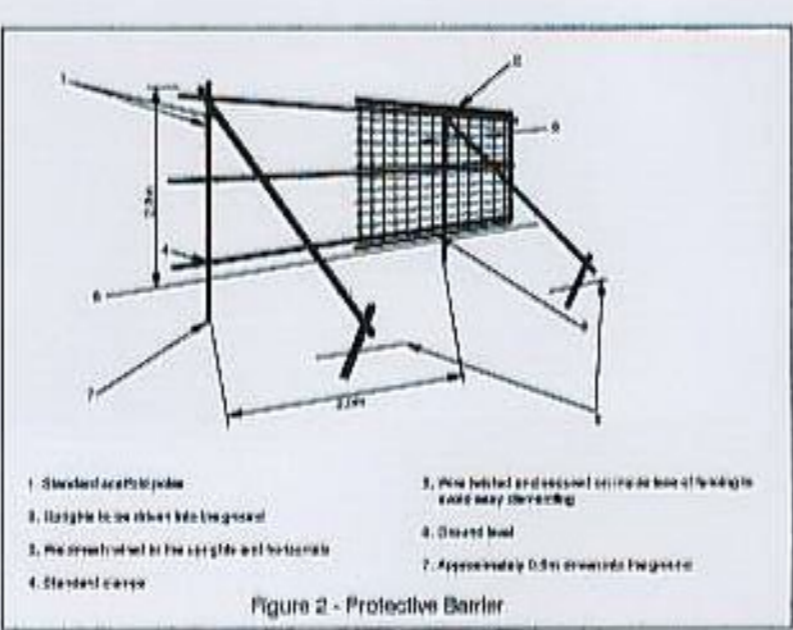

Key to Schedule of Trees

Tree No: Unique number corresponding with number on plan
 Species: English name
 Ht: Height in metres
 Branch Spread: Branch spread in metres taken at each of the cardinal points
 Stem Dia: Stem diameter in centimetres measured at 1.5m above ground level
 Multi-stemmed trees measured at base of stem just above root base
 Estimated where measurement unobtainable. All tree heights are estimated
 Ht of crown: Height in metres between ground level and underside of canopy
 Age Class: Y - less than one third natural life span spent
 M - between one third and two thirds natural life span
 O - greater than two thirds natural life span completed
 OM - overmature
 V - veteran
 The contribution Category: Anticipated useful life remaining in years
 Summary of BS 5837:2005 categorisation
 R - trees to be removed
 A - trees of high quality and value
 B - trees of moderate quality and value
 C - trees of low quality and value
 Fr - Fruit trees
 s - shrubs or small trees below survey threshold

TREE CATEGORY

- R (Red)
- A (Green)
- B (Blue)
- C (Black)

COLOUR VERSION ONLY

Do not scale from this drawing; all dimensions to be checked on site.
 The copyright of this document resides with Ian Keen Limited unless assigned in writing by the company.

IAN KEEN LIMITED